

Polyamide Metric & PG Locknuts
Suitable for the SWA range of polyamide CGLNM & PG cable glands

Lock Nuts, Flanged, Polyamide

- For standard industrial applications;
- For safe fastening of cable glands;
- Flanged design offers safe sealing;



Technical Details		
Material	PA 6 GF30 (Polyamide 6, 30% Glass Fiber reinforced)	
Flammability	HB according to UL94	
Operating Temperature	Permanent	-20 °C to +100 °C
	Intermittent	-30 °C to +150 °C
Thread Type	Metric EN 60423 PG DIN 40430	

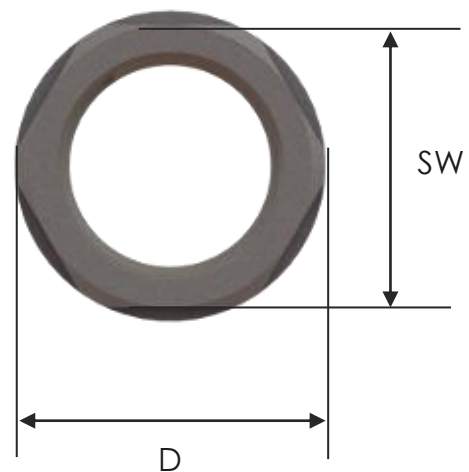
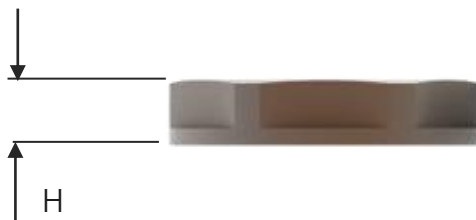

Thread Type METRIC acc. To EN 60423

SWA Part No	Size	SW mm	D mm	H mm
PLNM12*	M12 x 1.5	18	19.5	5.0
PLNM16*	M16 x1.5	22	24.2	5.0
PLNM20*	M20 x 1.5	26	28.6	6.0
PLNM25*	M25 x 15	32	35.0	6.0
PLNM32*	M32 x 1.5	41	46.1	7.0
PLNM40*	M40 x 1.5	50	55.3	7.0
PLNM50*	M50 x 1.5	60	66.1	8.0
PLNM63*	M63 x 1.5	75	82.5	8.0

* Specify colour required

Thread Type PG acc. To DIN 40430

SWA Part No	Size	SW mm	D mm	H mm
PLNPG7 -*	PG 7	19	21.0	5.0
PLNPG9 -*	PG 9	22	24.0	5.0
PLNPG11 -*	PG 11	24	26.0	5.0
PLNPG13.5 -*	PG 13,5	27	29.0	6.0
PLNPG16 -*	PG 16	30	33.0	6.0
PLNPG21 -*	PG 21	36	39.0	7.0
PLNPG28 -*	PG 29	46	50.0	7.0
PLNPG36 -*	PG 36	60	66.0	8.0
PLNPG42 -*	PG 42	65	73.0	8.0
PLNPG48 -*	PG 48	70	78.0	8.0

* Specify colour required