

Cable terminations

Copper tube terminals

T Range (1.5mm² - 6.0mm²)

Application: Un-insulated heavy duty terminals suitable for power cables up to 1000 volts.

Material: Manufactured from seamless copper tube to BS EN 12449:2016

Finish: Electro Tin plated to BS 1872:1984



- Tensile and electrical performance requirements to BS EN 61238-1:2003
- All terminals are manufactured from 99.5% copper and double annealed to ensure optimum ductility to avoid severe deformation such as cracking and splitting when crimped

- Terminals are supplied with an inspection window which enables the user to ensure full and correct insertion of the conductor and a flared or chamfered entry ensures a smooth transition from terminal to conductor
- High temperature versions available (subject to M.O.Q.)

- All SWA terminals are identified with the unique SWA part number denoting cable size and stud hole size for full traceability to ensure correct selection of the appropriate tool and dies

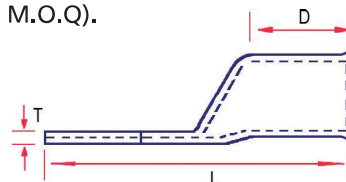
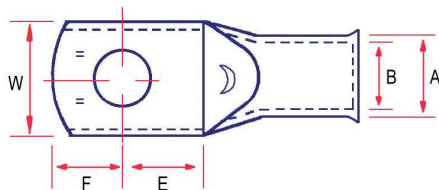

Tool Selection

Cond. Size mm ² Strand/Flex	Part No.	Pack Qty	Stud Hole	Dimensions in mm								Tool Selection				
				A	B	W	E	F	D	L	T	Mechanical crimp tools		Hydraulic/Battery crimp tools		
1.5*/1.5	1.5-4T	100	M4	3.3	1.8	8.5	6.0	6.0	6.0	6.0	18.0	0.8	Y	Y	Y	Y
	1.5-5T	100	M5	3.3	1.8	9.5	6.0	6.0	6.0	6.0	20.0	0.8	Y	Y	Y	Y
	1.5-6T	100	M6	3.3	1.8	10.5	6.0	6.0	6.0	6.0	20.0	0.8	Y	Y	Y	Y
2.5*/2.5	2.5-4T	100	M4	4.2	2.4	8.5	6.0	6.0	6.0	7.0	19.0	1.0	Y	Y	Y	Y
	2.5-5T	100	M5	4.2	2.4	9.5	6.0	6.0	6.0	7.0	21.0	1.0	Y	Y	Y	Y
	2.5-6T	100	M6	4.2	2.4	10.5	6.0	6.0	6.0	7.0	21.0	0.8	Y	Y	Y	Y
4*/4	4-4T	100	M4	5.0	3.0	8.5	6.0	5.5	9.0	25.0	1.3					
	4-5T	100	M5	5.0	3.0	9.5	6.0	6.0	9.0	25.0	1.1					
	4-6T	100	M6	5.0	3.0	10.5	9.5	6.0	9.0	25.0	1.0					
	4-8T	100	M8	5.0	3.5	12.0	9.5	9.5	9.0	33.0	1.0					
	4-10T	100	M10	5.0	3.5	14.0	9.5	9.5	9.0	33.0	1.0					
6*/6	6-4T	100	M4	6.0	4.0	8.0	6.0	6.0	9.0	28.0	1.6					
	6-5T	100	M5	6.0	4.0	9.0	6.0	6.0	9.0	28.0	1.6					
	6-6T	100	M6	6.0	4.0	11.0	6.0	6.0	9.0	28.0	1.4					
	6-8T	100	M8	6.0	4.0	13.0	9.5	9.5	10.0	35.0	1.1					
	6-10T	100	M10	6.0	4.0	14.5	9.5	9.5	10.0	35.0	1.0					

* Denotes chamfered cable entry

Cable terminations

Copper tube terminals

TQ™ Range – B.S. Approved (400mm² - 630mm²)

Cond. Size mm ² Strand/Flex	Part No.	Pack Qty	Stud Hole	Dimensions in mm								SUPPLIED WITH DIES	Tool Selection				
				A	B	W	E	F	D	L	T		Hydraulic/Battery crimp tools				
												Y	Y	Y	Y	Y	
400 / -	400-10TQ	5	M10	32.0	27.0	47.3	25.0	25.0	38.0	113.0	5.0	Y	Y	Y	Y	Y	
	400-12TQ	5	M12	32.0	27.0	47.3	25.0	25.0	38.0	113.0	5.0	Y	Y	Y	Y	Y	
	400-14TQ	5	M14	32.0	27.0	47.3	25.0	25.0	38.0	113.0	5.0	Y	Y	Y	Y	Y	
	400-16TQ	5	M16	32.0	27.0	47.3	25.0	25.0	38.0	113.0	5.0	Y	Y	Y	Y	Y	
	400-20TQ	5	M20	32.0	27.0	47.3	25.0	25.0	38.0	113.0	5.0	Y	Y	Y	Y	Y	
500* / -	500-12TQ	2	M12	38.1	30.0	55.0	29.0	25.0	44.0	127.0	8.2	Y	Y	Y	Y	Y	
	500-14TQ	2	M14	38.1	30.0	55.0	29.0	25.0	44.0	127.0	8.2	Y	Y	Y	Y	Y	
	500-16TQ	2	M16	38.1	30.0	55.0	29.0	25.0	44.0	127.0	8.2	Y	Y	Y	Y	Y	
	500-20TQ	2	M20	38.1	30.0	55.0	29.0	25.0	44.0	127.0	8.2	Y	Y	Y	Y	Y	
630* / -	630-12TQ	2	M12	44.0	33.8	63.0	25.0	23.0	46.0	127.0	10.2	Y	Y	Y	Y	Y	
	630-14TQ	2	M14	44.0	33.8	63.0	25.0	23.0	46.0	127.0	10.2	Y	Y	Y	Y	Y	
	630-16TQ	2	M16	44.0	33.8	63.0	25.0	23.0	46.0	127.0	10.2	Y	Y	Y	Y	Y	
	630-20TQ	2	M20	44.0	33.8	63.0	25.0	23.0	46.0	127.0	10.2	Y	Y	Y	Y	Y	

*Denotes chamfered cable entry

4 Hole Transformer Fixing Terminals

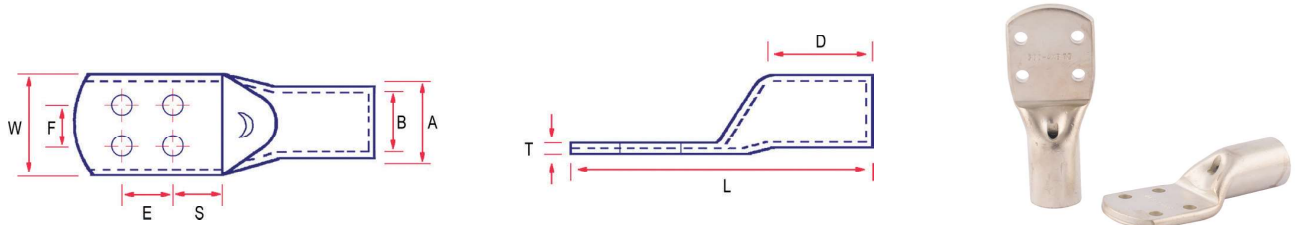

Part No.			Dimensions in mm								
8mm Stud Hole	10mm Stud Hole	Cable Size mm ²	A	B	W	E	F	D	L	S	T
120-4 x 8TFQ	120-4 x 10TFQ	120	19.0	15.0	56.0	25.0	35.0	34.0	119.0	17.0	4.0
150-4 x 8TFQ	150-4 x 10TFQ	150	21.0	16.5	56.0	25.0	35.0	34.0	119.0	17.0	4.5
185-4 x 8TFQ	185-4 x 10TFQ	185	23.0	18.5	56.0	25.0	35.0	34.0	119.0	17.0	4.5
240-4 x 8TFQ	240-4 x 10TFQ	240	26.0	21.0	56.0	25.0	35.0	34.0	119.0	17.0	5.0
300-4 x 8TFQ	300-4 x 10TFQ	300	28.0	23.0	56.0	25.0	35.0	42.0	126.0	17.0	7.0
400-4 x 8TFQ	400-4 x 10TFQ	400	32.0	27.0	56.0	25.0	35.0	44.0	126.0	17.0	8.5
500-4 x 8TFQ	500-4 x 10TFQ	500	38.0	30.0	56.0	25.0	35.0	65.0	150.0	17.0	8.0
630-4 x 8TFQ	630-4 x 10TFQ	630	44.0	34.0	63.0	25.0	35.0	65.0	150.0	17.0	10.0

All chamfered entry

For recommended tooling refer to TQ terminals.